



**REPUBLIC OF NAURU  
GOVERNMENT GAZETTE  
PUBLISHED BY AUTHORITY**

No. 20

13<sup>th</sup> February, 2013

Nauru

G.N. No. 113 / 2013

Determination of the Beneficiaries of the Estate of the late BINEA AKU of Meneñ District.

**ESTATE**

1. The Nauru Lands Committee has ascertained that the late BINEA AKU had been determined by the decisions of the Nauru Lands Committee (or its predecessor the Lands Committee) to be the owner of the following lands:-

DISTRICT	PORTION NO.	TYPE OF LAND	NAME OF LAND	GAZETTE NOTICE OF OWNERSHIP	SHARE
Ewa	204	c.l	Boroboron	17/88	1/49
Ijuw	31	c.l	Ganakoro	17/88	1/49
Iju	125	p.l	Anengin	8/89	1/49
Anibare	324	c.l	Ate	17/88	1/98
Ijuw	77	p.l	Ijibab	17/88	1/98
Anibare	100	c.l	Aribaeong	17/88	1/147
Anibare	217	p.l	Atekapara	17/88	1/147
Baiti	82	p.l	Ugino	17/88	1/196
Ewa	7	c.l	Aruro	17/88	1/196
Ewa	26	p.l	Arida	17/88	1/196
Ewa	144	c.l	Anuer	17/88	1/196
Ewa	153	c.l	Mamweiya	17/88	1/196
Ewa	186	c.l	Boroboron	17/88	1/196
Ijuw	7	p.l	Ebara	17/88	1/196
Ijuw	34	c.l	Ganokoro	17/88	1/196
Ijuw	35	c.l	Eatdabuarik	17/88	1/196
Ijuw	53	c.l	Ganokoro	17/88	1/196
Ijuw	100	p.l	Iako	17/88	1/196
Ijuw	115	p.l	Aeiw	51/88	1/196
Ijuw	120	p.l	Atajong	61/90	1/196
Ijuw	126	c.l	Iatoborobor	6/92	1/196
Anibare	121	c.l	Anuquoge	17/88	1/294
Anibare	188	p.l	Atoredeto	17/88	1/294

**DETERMINATION OF BENEFICIARIES**

2. The Nauru Lands Committee has determined that the beneficiaries of the estate of the late BINEA AKU are: - (a) in respect of the land shown in paragraph 1 above.

DISTRICT	PORTION NO.	NAME OF LAND	BENEFICIARIES	SHARE
Ewa	204	Boroboron		
		Penina D (T/TEE)	Varomue Deireragea	1/245
		Perina A (T/TEE)	Sheerah Aku	1/245
			Kassim Aku	1/245
			Gemma Naomi Aku	1/245
			Gary Aku (LTO)	1/245

G.N. No. 113 / 2013 (cont'd)

Ijuw	31	Ganakoro	As for portion No. 204 c.1	Ewa
Iju	125	Anengin	-do-	
Anibare	324	Ate		
		Penina D (T/TEE)	Varomue Deireragea	1/490
		Perina A (T/TEE)	Sheerah Aku	1/490
			Kassim Aku	1/490
			Gemma Naomi Aku	1/490
			Gary Aku (LTO)	1/490
Ijuw	77	Ijibab	As for portion No. 324 c.1	Anibare
Anibare	100	Aribaeong		
		Penina D (T/TEE)	Varomue Deireragea	1/735
		Perina A (T/TEE)	Sheerah Aku	1/735
			Kassim Aku	1/735
			Gemma Naomi Aku	1/735
			Gary Aku (LTO)	1/735
Anibare	217	Atekapara	As for portion No. 100 c.1	Anibare
Baiti	82	Ugino		
		Penina D (T/TEE)	Varomue Deireragea	1/980
		Perina A (T/TEE)	Sheerah Aku	1/980
			Kassim Aku	1/980
			Gemma Naomi Aku	1/980
			Gary Aku (LTO)	1/980
Ewa	7	Aruro	As for portion No. 82 p.1	Baiti
Ewa	26	Arida	-do-	
Ewa	144	Anuer	-do-	
Ewa	153	Mamweiya	-do-	
Ewa	186	Boroboron	-do-	
Ijuw	7	Ebara	-do-	
Ijuw	34	Ganokoro	-do-	
Ijuw	35	Eatdabuarik	-do-	
Ijuw	53	Ganokoro	-do-	
Ijuw	100	Iako	-do-	
Ijuw	115	Aeiw	-do-	
Ijuw	120	Atajong	-do-	
Ijuw	126	Iatoborobor	-do-	
Anibare	121	Anuquoge		
		Penina D (T/TEE)	Varomue Deireragea	1/1470
		Perina A (T/TEE)	Sheerah Aku	1/1470
			Kassim Aku	1/1470
			Gemma Naomi Aku	1/1470
			Gary Aku (LTO)	1/1470
Anibare	188	Atoredeto	-do-	

Note: Those who disagree with the above distribution may appeal to the Supreme Court Registry within 21 days of the publication of the Government Notice.

**TYRAN CAPELLE**  
**CHAIRPERSON – NAURU LANDS COMMITTEE**

G.N. No. 114 / 2013

Determination of the Beneficiaries of the Estate of the late TREDEN AMRAM of Ewa District.

**ESTATE**

1. The Nauru Lands Committee has ascertained that the late TREDEN AMRAM had been determined by the decisions of the Nauru Lands Committee (or its predecessor the Lands Committee) to be the owner of the following lands:-

DISTRICT	PORTION NO.	TYPE OF LAND	NAME OF LAND	GAZETTE NOTICE OF OWNERSHIP	SHARE
Anabar	19	p.l	Mogaiya	59/10	1/1008
Anabar	68	p.l	Anni	59/10	1/1008
Buada	62	p.l	Ijakabab	59/10	1/1008
Ewa	98	p.l	Ebwenweije	59/10	1/1008
Anetan	14	p.l	Ibuti	59/10	1/168
Anetan	39	c.l	Ronauwi	59/10	1/168
Anetan	40	c.l	Aruwangada	59/10	1/168
Ijuw	20	p.l	Aniyuw	59/10	1/168
Baiti	4	p.l	Anadere	59/10	1/2016
Baiti	178	p.l	Anoe	59/10	1/2016
Baiti	82	p.l	Ugino	59/10	1/336
Ewa	7	c.l	Arubo	59/10	1/336
Ewa	26	p.l	Arida	59/10	1/336
Ewa	144	c.l	Anuer	59/10	1/336
Ewa	153	c.l	Mamweiya	59/10	1/336
Ewa	186	c.l	Boroboron	59/10	1/336
Ijuw	7	p.l	Ebara	59/10	1/336
Ijuw	34	c.l	Ganokoro	59/10	1/336
Ijuw	35	c.l	Eatdabuarik	59/10	1/336
Ijuw	53	c.l	Ganokoro	59/10	1/336
Ijuw	100	p.l	Iako	59/10	1/336
Ijuw	115	p.l	Aeiw	59/10	1/336
Ijuw	120	p.l	Atajong	59/10	1/336
Ijuw	126	c.l	Iatoborobor	59/10	1/336
Baiti	109	c.l	Magengeng	59/10	1/504
Buada	85	p.l	Aujo	59/10	1/1152
Buada	116	p.l	Urum	59/10	1/1152
Ewa	202	c.l	Boroboron	59/10	1/84
Meneñ	2	c.l	Kibaba	59/10	1/84
Meneñ	211	p.l	Anibubu	59/10	1/84
Yaren	183	c.l	Ajuwor, Apoe	59/10	1/84
Yaren	187	c.l	Ajuwur	59/10	1/84
Yaren	189	c.l	Aiyuwur	59/10	1/84
Yaren	197	c.l	Ijako	59/10	1/84
Yaren	203	c.l	Ijako	59/10	1/84
Yaren	299	p.l	Baraidona	59/10	1/84
Nibok	109	p.l	Eatomaneab	59/10	1/896
Nibok	112	p.l	Eatomaneab	59/10	1/896
Aiwo	114	p.l	Bwitiainmar	59/10	4/945
Aiwo	460	p.l	Bwitiemor	59/10	4/945
Aiwo	120	c.l	Ibige	59/10	1/756
Aiwo	132	c.l	Anerue	59/10	1/756
Aiwo	146	c.l	Eateraruo	59/10	1/756
Aiwo	151	c.l	Yatam	59/10	1/756

## G.N. No. 114 / 2013 (cont'd)

Aiwo	285	p.l	-	59/10	1/756
Aiwo	344	c.l	Ibige	59/10	1/756
Aiwo	405	c.l	Aiue	59/10	1/756
Aiwo	424	c.l	Anerue	59/10	1/756
Aiwo	425	c.l	Anerue	59/10	1/756
Baiti	41	p.l	Ungow	59/10	1/756
Buada	125	p.l	Animwen	59/10	1/756
Buada	323	c.l	Ata	59/10	1/756
Denigomodu	54	c.l	Baijoro	59/10	1/756
Denigomodu	265	c.l	Eatdogienae	59/10	1/756
Nibok	59	p.l	Ududin	59/10	1/756
Nibok	71	p.l	Ahn	59/10	1/756
Nibok	73	p.l	Yorearea, Yauria	59/10	1/756
Uaboe	41	p.l	Ura	59/10	1/756
Aiwo	150	c.l	Yatam	59/10	1/2268
Buada	104	p.l	Adenenera	59/10	1/2268
Buada	127	p.l	Adungidungin	59/10	1/2268
Aiwo	237	c.l	Yangor	59/10	1/945
Buada	291	c.l	Ianemara	59/10	1/945
Denigomodu	280	c.l	Ariyeyen	59/10	1/945
Buada	139	p.l	Anota	59/10	1/1512
Ewa	127	c.l	Aebure	59/10	1/1512
Anibare	147	p.l	Anueab	59/10	1/378
Denigomodu	72	p.l	Ijongidero	59/10	1/378
Denigomodu	83	p.l	Adeto	59/10	1/378
Denigomodu	253	p.l	Iderige	59/10	1/378
Ewa	97	p.l	Atagura	59/10	1/378
Uaboe	42	p.l	Anueab	59/10	1/378
Aiwo	19	c.l	Anbubu	59/10	1/567
Aiwo	466	c.l	Anbubu	59/10	1/567
Denigomodu	33	c.l	Atsiobouwa	59/10	1/567
Denigomodu	35	c.l	Anibubu	59/10	1/567
Denigomodu	144	c.l	Idarauwa	59/10	1/567
Denigomodu	149	c.l	Anpudu	59/10	1/567
Denigomodu	215	p.l	Anibubu	59/10	1/567
Denigomodu	70	p.l	Ijogidero	59/10	1/567
Denigomodu	221	p.l	-	59/10	1/567
Aiwo	21	c.l	-	59/10	1/189
Aiwo	22	p.l	-	59/10	1/189
Aiwo	351	c.l	Aterienago	59/10	1/189
Aiwo	450	p.l	Anibubu	59/10	1/189
Aiwo	457	p.l	Ubwtieimar	59/10	1/189
Anetan	9	p.l	Eatetebao	59/10	1/189
Buada	9	p.l	Yakabab	59/10	1/189
Buada	128	p.l	Eiroubar	59/10	1/189
Buada	151	p.l	Anota	59/10	1/189
Buada	298	c.l	Oebuebini	59/10	1/189
Denigomodu	68	c.l	Anota	59/10	1/189
Denigomodu	160	c.l	Darawa	59/10	1/189
Nibok	72	p.l	Adetoro	59/10	1/189
Nibok	107	p.l	Eateidinguwa	59/10	1/189
Nibok	111	p.l	Eateidinguwa	59/10	1/189
Nibok	115	p.l	Eateidinguwa	59/10	1/189

G.N. No. 114 / 2013 (cont'd)

Nibok	116	p.l	Eateidun	59/10	1/189
Buada	121	p.l	Yakabab	59/10	1/189
Anetan	12	p.l	Aemwar	59/10	1/3024
Denigomodu	42	c.l	Yanoror	59/10	4/2835
Nibok	114	p.l	Oquore	59/10	1/350

DETERMINATION OF BENEFICIARIES

2. The Nauru Lands Committee has determined that the beneficiaries of the estate of the late TREDEN AMRAM are: - (a) in respect of the land shown in paragraph 1 above.

DISTRICT	PORTION NO.	NAME OF LAND	BENEFICIARIES	SHARE
Anabar	19	Mogaiya		
		Bereka Redfern (T/TEE)	Subzina Kirira Ephraim	1/1008
Anabar	68	Anni	As for portion No. 19 p.l	Anabar
Buada	62	Ijakabab	-do-	
Ewa	98	Ebwenweije	-do-	
Anetan	14	Ibuti		
		Bereka Redfern (T/TEE)	Subzina Kirira Ephraim	1/168
Anetan	39	Ronauwi	As for portion No. 14 p.l	Anetan
Anetan	40	Aruwangada	-do-	
Ijuw	20	Aniyuw	-do-	
Baiti	4	Anadere		
		Bereka Redfern (T/TEE)	Subzina Kirira Ephraim	1/2016
Baiti	178	Anoe	As for portion No. 4 p.l	Baiti
Baiti	82	Ugino		
		Bereka Redfern (T/TEE)	Subzina Kirira Ephraim	1/336
Ewa	7	Arubo	As for portion No. 82 p.l	Baiti
Ewa	26	Arida	-do-	
Ewa	144	Anuer	-do-	
Ewa	153	Mamweiya	-do-	
Ewa	186	Boroboron	-do-	
Ijuw	7	Ebara	-do-	
Ijuw	34	Ganokoro	-do-	
Ijuw	35	Eatdabuarik	-do-	
Ijuw	53	Ganokoro	-do-	
Ijuw	100	Iako	-do-	
Ijuw	115	Aeiw	-do-	
Ijuw	120	Atajong	-do-	
Ijuw	126	Iatoborobor	-do-	
Baiti	109	Magengeng		
		Bereka Redfern (T/TEE)	Subzina Kirira Ephraim	1/504
Buada	85	Aujo		
		Bereka Redfern (T/TEE)	Subzina Kirira Ephraim	1/1152
Buada	116	Urum	As for portion No. 85 p.l	Buada
Ewa	202	Boroboron		
		Bereka Redfern (T/TEE)	Subzina Kirira Ephraim	1/84
Meneñ	2	Kibaba	As for portion No. 202 c.l	Ewa
Meneñ	211	Anibubu	-do-	
Yaren	183	Ajuwor, Apoe	-do-	
Yaren	187	Ajuwur	-do-	
Yaren	189	Aiyuwur	-do-	

G.N. No. 114 / 2013 (cont'd)

Yaren	197	Ijako	-do-	
Yaren	203	Ijako	-do-	
Yaren	299	Baraidona	-do-	
Nibok	109	Eatomaneab		
		Bereka Redfern (T/TEE)	Subzina Kirira Ephraim	1/896
Nibok	112	Eatomaneab	As for portion No. 109 p.1	Nibok
Aiwo	114	Bwitiaimar		
		Bereka Redfern (T/TEE)	Subzina Kirira Ephraim	4/945
Aiwo	460	Bwitiemor	-do-	
Aiwo	120	Ibige		
		Bereka Redfern (T/TEE)	Subzina Kirira Ephraim	1/756
Aiwo	132	Anerue	As for portion No. 120 c.1	Aiwo
Aiwo	146	Eateraruo	-do-	1/756
Aiwo	151	Yatam	-do-	1/756
Aiwo	285	-	-do-	1/756
Aiwo	344	Ibige	-do-	1/756
Aiwo	405	Aiue	-do-	1/756
Aiwo	424	Anerue	-do-	1/756
Aiwo	425	Anerue	-do-	1/756
Baiti	41	Ungow	-do-	1/756
Buada	125	Animwen	-do-	1/756
Buada	323	Ata	-do-	1/756
Denigomodu	54	Baijoro	-do-	1/756
Denigomodu	265	Eatdogienae	-do-	1/756
Nibok	59	Ududin	-do-	1/756
Nibok	71	Ahn	-do-	1/756
Nibok	73	Yorearea, Yauria	-do-	1/756
Uaboe	41	Ura	-do-	1/756
Aiwo	150	Yatam		
		Bereka Redfern (T/TEE)	Subzina Kirira Ephraim	1/2268
Buada	104	Adenenera	As for portion No. 150 c.1	Aiwo
Buada	127	Adungidungin	-do-	
Aiwo	237	Yangor		
		Bereka Redfern (T/TEE)	Subzina Kirira Ephraim	1/945
Buada	291	Ianemara	As for portion No. 237 c.1	Aiwo
Denigomodu	280	Ariyeyen	-do-	
Buada	139	Anota		
		Bereka Redfern (T/TEE)	Subzina Kirira Ephraim	1/1512
Ewa	127	Aebure	As for portion No. 139 p.1	Buada
Anibare	147	Anueab		
		Bereka Redfern (T/TEE)	Subzina Kirira Ephraim	1/378
Denigomodu	72	Ijongidero	As for portion No. 147 p.1	Anibare
Denigomodu	83	Adeto	-do-	
Denigomodu	253	Iderige	-do-	
Ewa	97	Atagura	-do-	
Uaboe	42	Anueab	-do-	
Aiwo	19	Anbubu		
		Bereka Redfern (T/TEE)	Subzina Kirira Ephraim	1/567
Aiwo	466	Anbubu	As for portion No. 19 c.1	Aiwo
Denigomodu	33	Atsioubouwa	-do-	1/567
Denigomodu	35	Anibubu	-do-	1/567
Denigomodu	144	Idarauwa	-do-	1/567
Denigomodu	149	Anpudu	-do-	1/567

G.N. No. 114 / 2013 (cont'd)

Denigomodu	215	Anibubu	-do-	1/567
Denigomodu	70	Ijogidero	-do-	1/567
Denigomodu	221	-	-do-	1/567
Aiwo	21	-		
		Bereka Redfern (T/TEE)	Subzina Kirira Ephraim	1/189
Aiwo	22	-	As for portion No. 21 c.1	Aiwo
Aiwo	351	Aterienago	-do-	1/189
Aiwo	450	Anibubu	-do-	1/189
Aiwo	457	Ubwitieimar	-do-	1/189
Anetan	9	Eatetebao	-do-	1/189
Buada	9	Yakabab	-do-	1/189
Buada	128	Eiroubar	-do-	1/189
Buada	151	Anota	-do-	1/189
Buada	298	Oebuebini	-do-	1/189
Denigomodu	68	Anota	-do-	1/189
Denigomodu	160	Darawa	-do-	1/189
Nibok	72	Adetoro	-do-	1/189
Nibok	107	Eateidinguwa	-do-	1/189
Nibok	111	Eateidinguwa	-do-	1/189
Nibok	115	Eateidinguwa	-do-	1/189
Nibok	116	Eateidun	-do-	1/189
Buada	121	Yakabab	-do-	1/189
Anetan	12	Aemwar		
		Bereka Redfern (T/TEE)	Subzina Kirira Ephraim	1/3024
Denigomodu	42	Yanoror		
		Bereka Redfern (T/TEE)	Subzina Kirira Ephraim	4/2835
Nibok	114	Oquore	-do-	

Note: Those who disagree with the above distribution may appeal to the Supreme Court Registry within 21 days of the publication of the Government Notice.

**TYRAN CAPELLE**  
**CHAIRPERSON – NAURU LANDS COMMITTEE**

G.N. No. 115 / 2013

It is notified for general information that in Government Gazette No. 124/2012 G.N. No. 502/2012, 503/2012 & 504/2012, the following maps are additional to the aforementioned notice.

MAP OF BOE: Portion No. 189, c.1, Ubwewewi

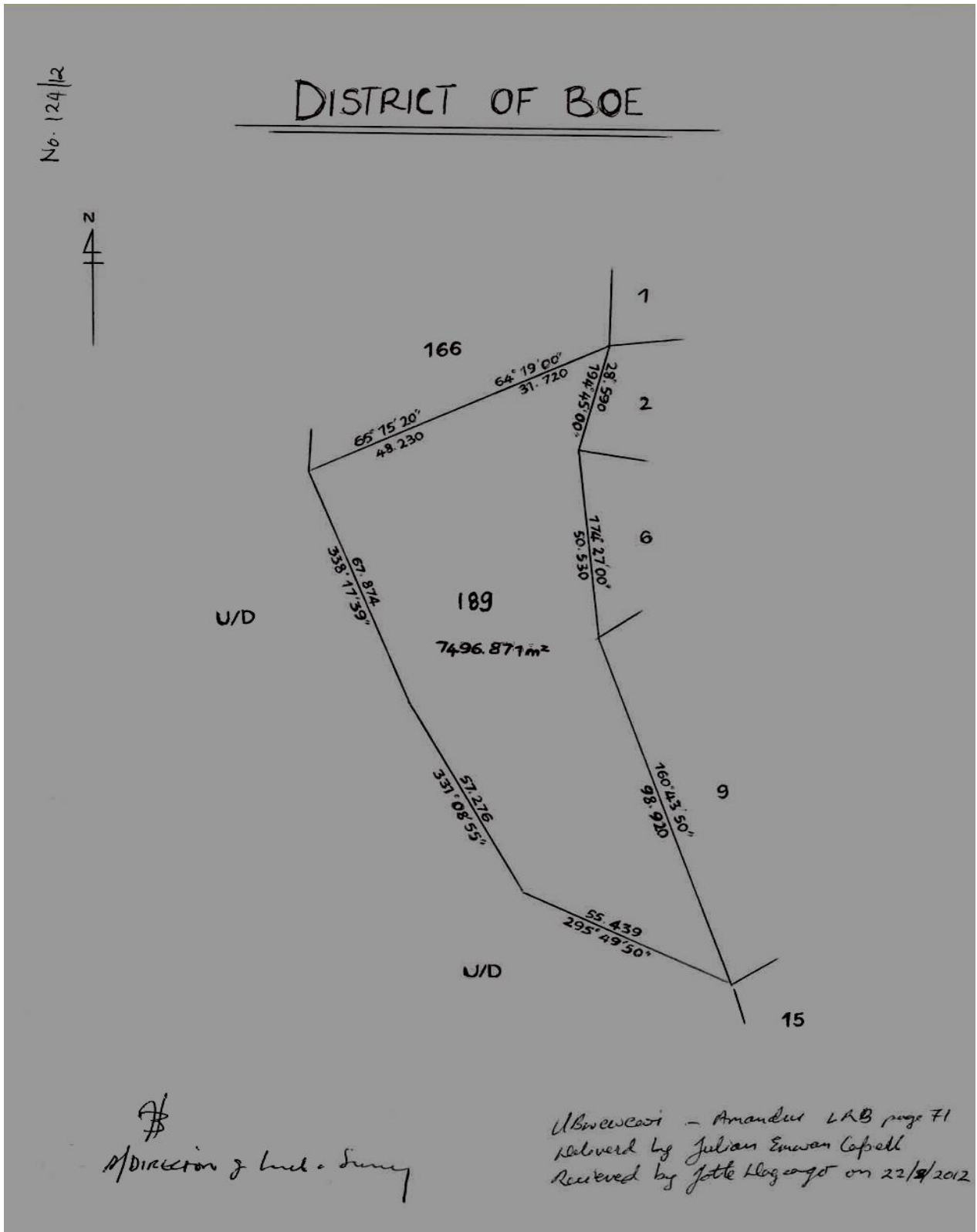



G.N. No. 115 / 2013 (cont'd)

MAP OF BUADA: Portion No. 402, c.l, Animaeor

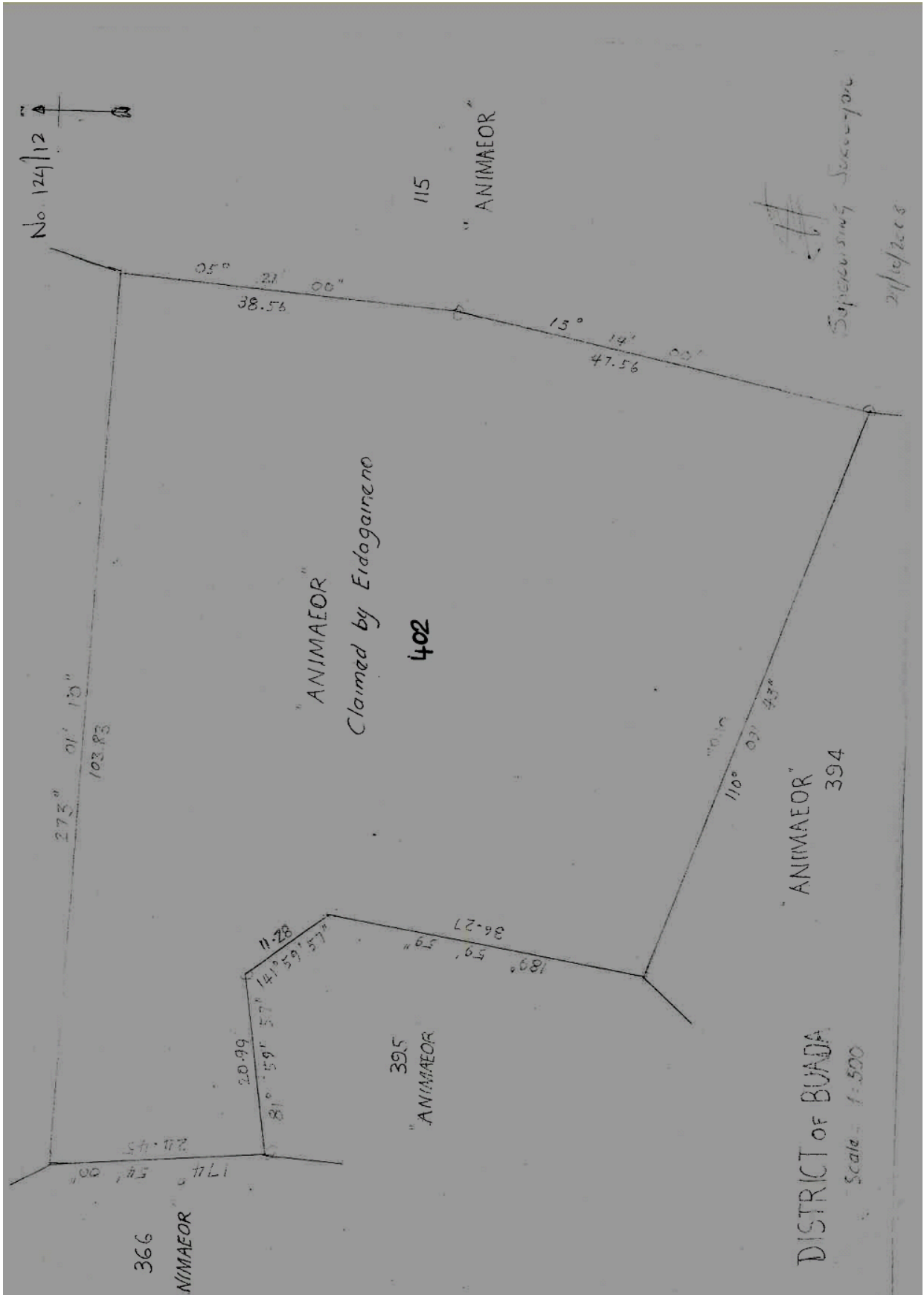

G.N. No. 115 / 2013 (cont'd)

MAP OF BUADA: Portion No. 398, c.l, Aninapwe

